

Series TE14 | Loops to be opened along the outer radius

Series TZ14 | Loops to be opened along the inner radius

To be opened along the outer radius	To be opened along the inner radius	R Bending radii [mm]	Weight [kg/m]
TE14. 50. R .0*	TZ14. 50. R .0	028 038 048 075 100 125	≈ 0,15

*also available as RBR (Reverse bending radius) Part No. TE14.50.Radius/Radius

Supplement Part No. with required radius (**R**). Example: TE14.50.100.0

Dimensions

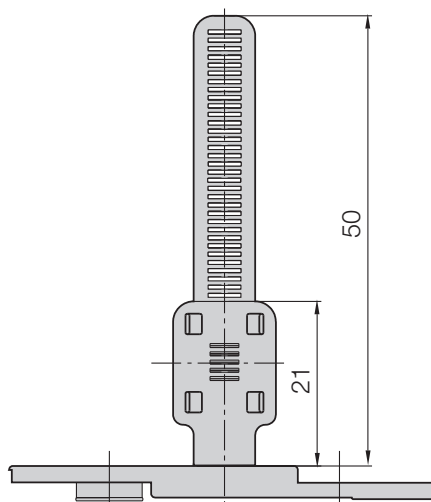
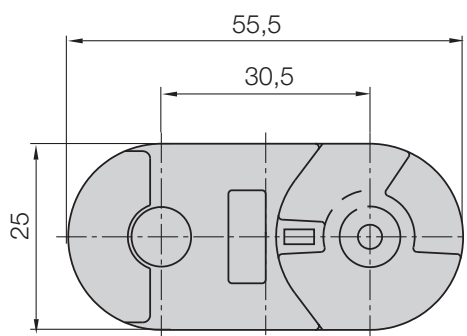

Pitch 30,5 mm/link
 Links/m 33 (1006,5 mm)
 Chain length $s/2 + K$

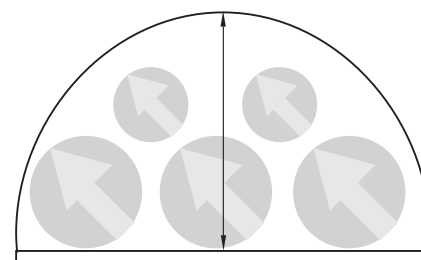

Cable package max.: 18 mm